

## Installation Information

### Item #P1018

### Gooseneck Leg Tub Faucet with Variable Centers

Warranted only when installed by a qualified, licensed plumber. Please use Teflon tape on all threaded connections.

1. Shut off the water supply to the fixture before installation.
2. Thread the shorter end of the hook-up inlet tubes into the backside of the swing arm coupler. Loosely tighten the swing arm couplers to allow for the centers adjustment.
3. Insert the inlet nipples through the 2 holes on the tub. Screw the lock nuts onto the threaded nipples and tighten to secure the faucet to your tub.
4. Tighten the nut on the coupler to secure to the faucet body at the desired placement.
5. Attach your supply lines to the 1/2" IPS faucet inlet tubes.
6. Make no adjustments to valves or valve stems. They are tested at the factory for optimum performance.

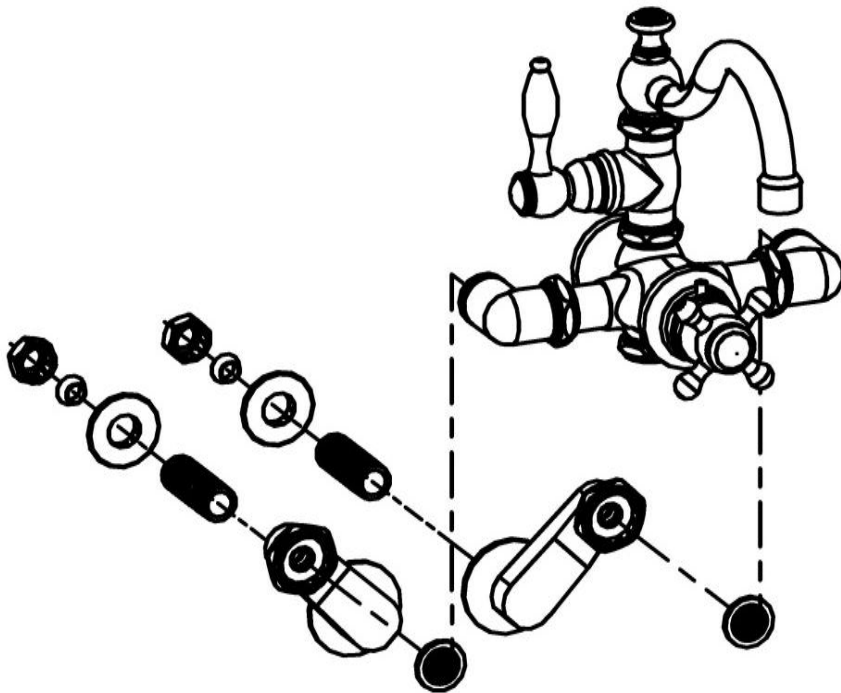

#### Parts Included:

- Faucet Body w/Arch Spout
- Swing Arms (pair)
- Handles (2)
- 1/2" IPS Inlet Nipples (2)
- Lock Down Nuts (2)
- Supply Nut/ Washer (2)

**Leg tub filler outlet shall be installed minimum 2" above the flood level rim of the fixture**