

## Installation Information

Item #P0892

Thermostatic Exposed Shower Unit, 7" Centers

Warranted only if installed by a qualified licensed plumber. Use Teflon tape on all threaded connections.

1. The rough-in centers for this unit is 7" on center. Determine how far from the shower pan the rough-in should be according to the final placement of the unit. This unit when installed has an approximate 6" forward offset from the floor rough-in.
2. Please note that all threaded pipe connections have been epoxied and tested at the factory.
3. Rough-in 1/2" IPS Female connection at the floor, about 1/2" above the finished floor.
4. Loosen the union nut below the shut off valve in order to remove the short nipples from the valve. Slide the escutcheon up the nipple before threading the nipple into the 1/2" IPS Female connection at the floor. Use a strap wrench or protected smooth jaw wrench to protect the finish while tightening. *TIP: Wrap your wrench mouth in duct tape to prevent scratching the finish of the unit during installation.*
5. Re-connect the bottom nipples to the unions of the supply risers and tighten. The Thermostatic Unit may now be attached to the supply risers by tightening the elbow nuts.
6. Insert the 36" riser into the unit and tighten the compression nut to seal the riser connection.
7. Attach the wall bracket escutcheons to the wall at desired height. The 12" wall supports can be cut to length by cutting the non-threaded end only. Thread on the c-clamps and secure to riser.
8. Attach the shower head to the arm using Teflon tape.
9. Install the handheld bracket to the elbow outlet on the unit.
10. Attach the nut end of the hose to the elbow outlet on the unit and connect the tapered end of the hose to the handheld unit. Place handheld shower in bracket.

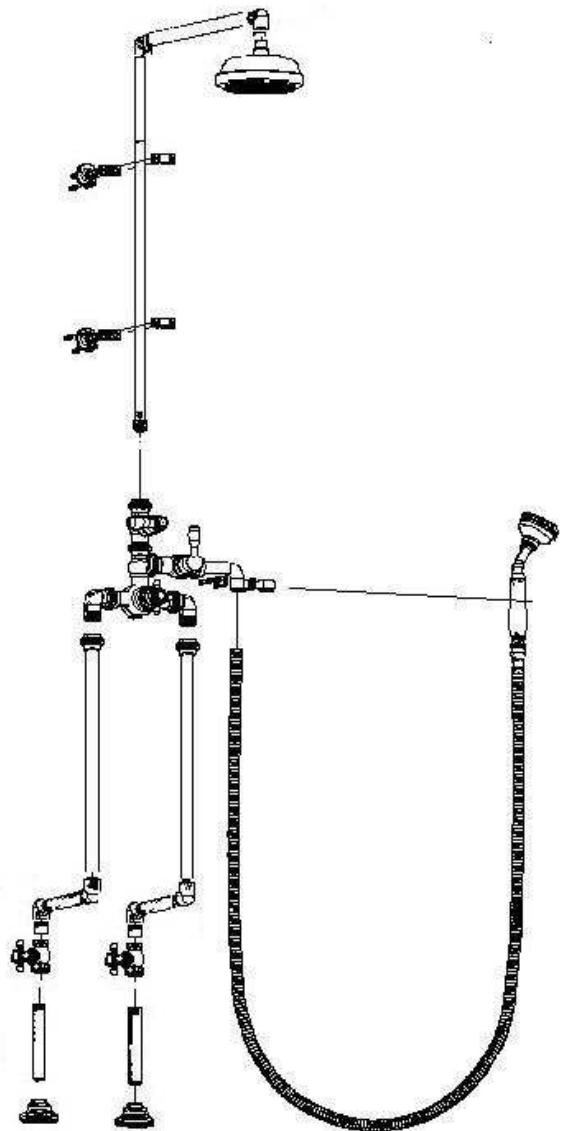

TOTAL HEIGHT IS APPROXIMATELY 88"