

Strom Plumbing

BY

Sign of  the Crab

Suggested Retail Price List Tub Zone Shipping Chart Specifications & Measurements

For Catalog No. 1201
Effective January 1, 2012

Prices are subject to change without notice. Unless price is protected in writing, shipments will be at the prevailing prices.

3756 Omec Circle
Rancho Cordova, CA 95742
(916) 638-2722 / (800) 843-2722
Fax (916) 638-2725
www.signofthecrab.com
sales@signofthecrab.com

Warranty & Product Information

Orders will only be accepted from established accounts and qualified new accounts. We sell only to the plumbing trade and there is no direct purchasing by retail customers.

All Products are Solid Brass

Our faucets are constructed with high quality, low lead brass. Our lavatory & kitchen faucets are lead free per California AB1953. They meet all current regulations with regard to lead composition. Each item is individually assembled and tested in the United States.

Valve Types

All faucets will be shipped with 1/4 turn ceramic valves. Our 1/4 turn ceramic cartridge uses 2 ceramic disks that rotate to open and lose the valve, minimizing mechanical wear. Thermostatic valves control the output of the faucet and keep the temperature constant.

Leg Tub Faucets

Our leg tub faucets are faithful reproductions of antique originals. Our British Telephone Series have Swing Arm Couplers installed for variable centers. All other faucets with standard inlet assemblies have 3 3/8" centers. All handheld shower units with hoses come with a vacuum breaker as part of the set. Our Thermostatic faucets include an anti-syphon device.

Lavatory Sets

Our Widespread Lavatory and Center Sets all include a pop-up drain. The widespread sets have 12" stainless steel flex hoses to vary the centers from 8" to 12". Use our sink trim kits on page 92 for our lavatory sets.

Installation Instructions

Installation Instructions are included with every faucet and are also available on our website.

Tub Warranty

Our tubs are warranted to be free of manufacturing and finish defects for a period of 5 years from date of purchase, when properly installed by a qualified, licensed plumber. In most cases on-site repair of the tub will be accomplished, minimizing the inconvenience to the customer. Our Cast Iron tubs are IAPMO approved.

Warranty

All items other than tubs are warranted to be free of manufacturing and finish defects for a period of 5 years from date of purchase, when properly installed by a qualified, licensed plumber. For items other than tubs & sinks, this warranty covers replacement of defective parts, not of complete product, unless deemed necessary by a customer service representative. The warranty does not extend to labor charges or air freight charges when repair or replacement of the item is needed. The warranty only applies to interior installations. Shower Curtains are not warranted.

Ceramic Handle Warranty

All our ceramic faucet handles are warranted for 5 years from date of purchase. Any ceramic faucet handle developing cracks or chips will be promptly replaced, as a cracked or broken handle may result in personal injury.

Finishes

Our finishes include Chrome, Matte Nickel, Polished Nickel, Supercoated Brass and Oil Rubbed Bronze. The Oil Rubbed Bronze ("non-living") is a fragile finish that must be inspected prior to installation and is not warranted further. The Nickel finishes are living finishes and will patina in time. Chrome & Nickel finishes are warranted against defect for a period of 5 years.

Care of Supercoat Brass

Supercoat brass items should be wiped gently with a soft cloth after each use. Plumber's putty should not be used for installation. Use of plumber's putty, detergents or abrasive cleaners will void the warranty of the finish as they may cause deterioration of the coating. We recommend a bead of waterproof silicone where putty is needed.

Lifetime Supercoat Warranty

Our Supercoating is a 2 part epoxy, applied electrostatically, and baked on to our brass products insure a lasting shine. It is absolutely guaranteed for as long as the original purchaser owns their home and proper maintenance instructions are followed. The product must be returned to our factory for re-coating. We will re-coat, not replace the product if a defect of the Supercoat finish occurs.

Price Changes

Prices and products are subject to change without notice. Unless price is protected in writing, shipments will be at prevailing prices.

Tub & Sink Freight Charges

Zone 1 States: \$150.00 per item

Zone 2 States: \$250.00 per item

Zone 1

Arizona
California
Idaho
Nevada
Oregon
Utah
Washington

Zone 2

Arkansas
Colorado
Iowa
Kansas
Minnesota
Missouri
Montana
Nebraska
New Mexico
North Dakota
Oklahoma
South Dakota
Texas
Wyoming

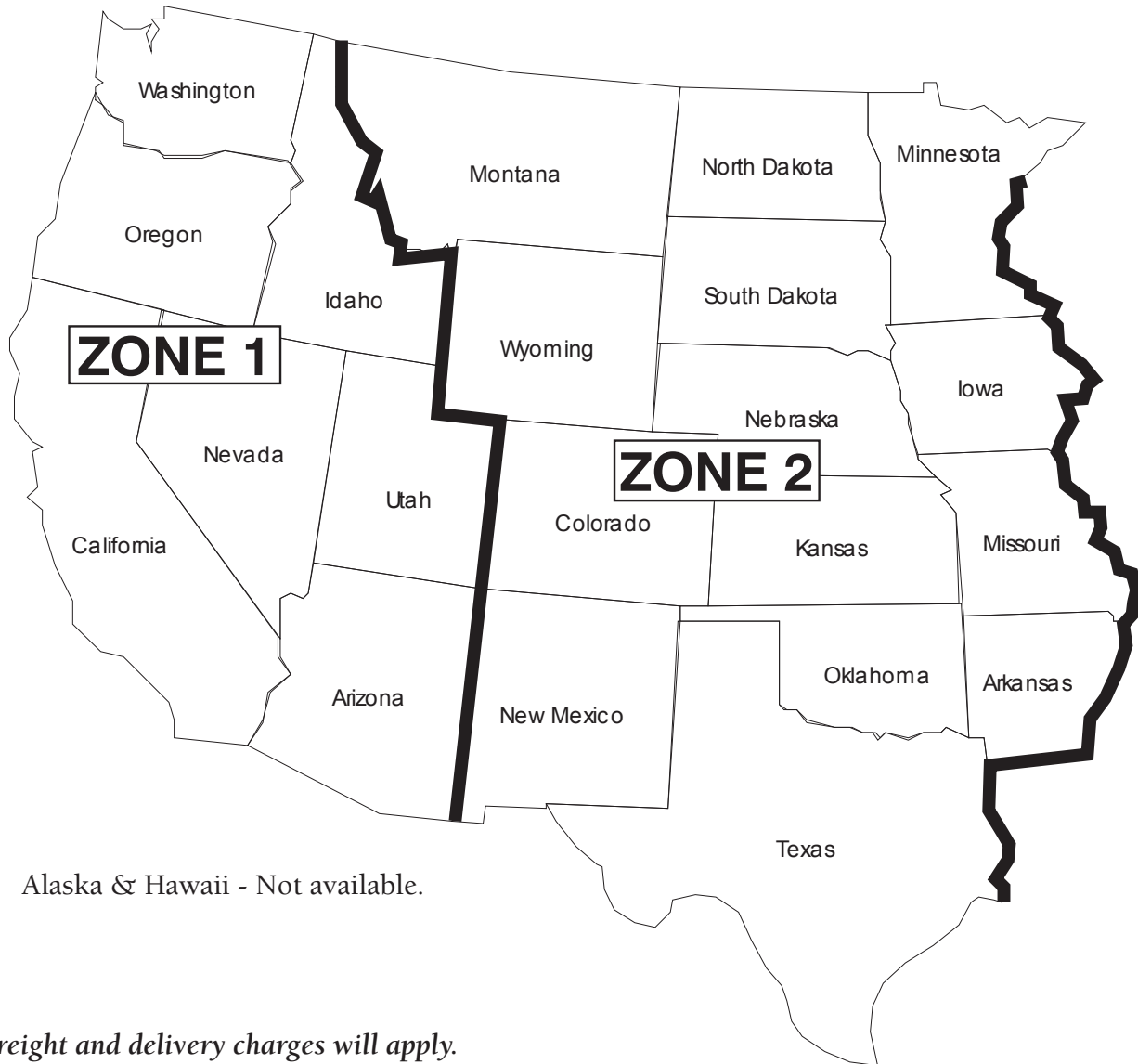

Alaska & Hawaii - Not available.

*Freight and delivery charges will apply.
See the chart for zoned freight charges and the price list for details.*

Tub & Sink Freight Charges

Zone 3 States: \$300.00 per item

Zone 4 States: \$350.00 per item

Zone 3

Alabama	Louisiana	South Carolina
Florida	Michigan	Tennessee
Georgia	Mississippi	Virginia
Illinois	North Carolina	West Virginia
Indiana	Ohio	Wisconsin
Kentucky	Pennsylvania	

Zone 4

Connecticut	New Hampshire
Delaware	New Jersey
Maine	New York
Maryland	Rhode Island
Massachusetts	Vermont

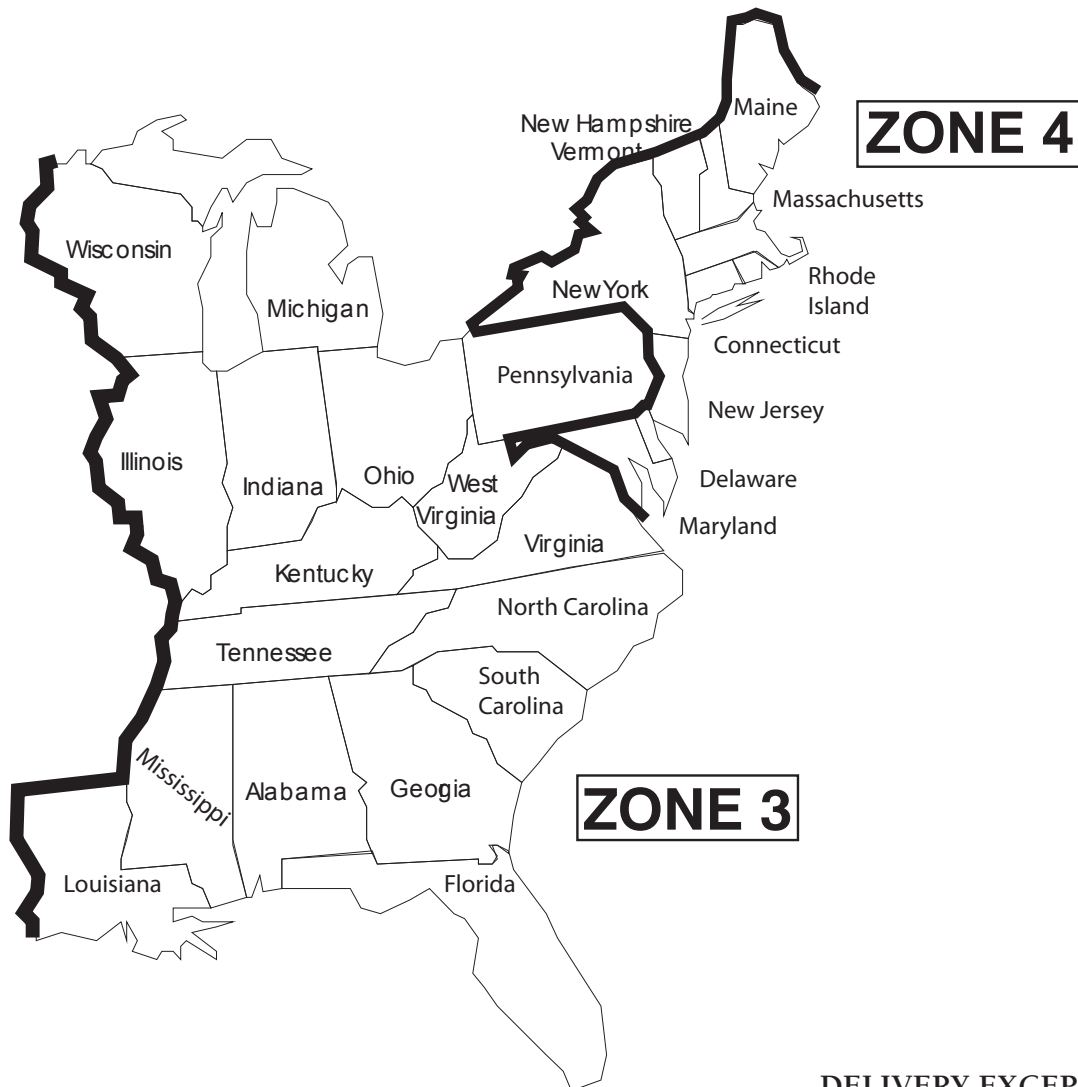

DELIVERY EXCEPTIONS:

Additional \$100.00 charge applies to Construction Site deliveries.

Installation Instructions
can be found on our website at

www.signofthecrab.com

or

www.stromplumbing.com

LEG TUB FAUCETS

ITEM #	SPOUT LENGTH / HEIGHT	CENTERS	WALL TO SPOUT EXT.
P0006	3 1/2"	3 3/8"	3 1/4"
P0126	9 3/4"	3 3/8"	5 3/8"
P0146*	4 1/2"	3 3/8" - 12"	7"
P0149-1	9 3/4"	3 3/8"	8"
P0400/P0402	9 3/4"	3 3/8"	8"
P0708	9 3/4"	3 3/8"	8"
P0793	9 3/4"	3 3/8"	8"
P0804	9 3/4"	3 3/8" - 9"	8"
P0889	5"	3 3/8" - 12"	7 1/2"
P1003	5"	3 3/8" - 12"	8"
P1004	7 1/2"	3 3/8"	11"
P1014	4 1/2"	3 3/8" - 12"	7"
P1017	8"	3 3/8" - 12"	10 1/2"
P1018	8"	3 3/8" - 12"	10 1/2"
P1026	9 3/4"	3 3/8"	8"

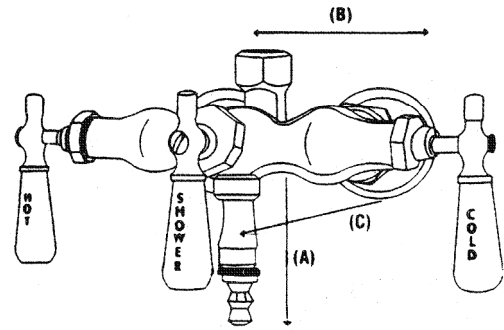

*minimum cc is 4 1/2" when mounting on a "bathroom wall" AND/OR any faucet that has P0166 swing arms added for wall mount installation.

DECK MOUNT FAUCETS

Maximum deck thickness is 1 1/8"

ITEM #	SPOUT EXTENSION	TOTAL HEIGHT	CLEARANCE	BASE DIA.	CENTER TO CENTER
P0341	7"	10"	2" BELOW DECK	2 1/8"	7"
P0462	7"	14"	2"	2 1/8"	7"
P0625	9"	ADJ.	ADJ.	2 1/8"	3 3/8" - 9"
P0626	8"	ADJ.	ADJ.	2 1/8"	3 3/8" - 12"
P0627	8"	ADJ.	ADJ.	2 1/8"	3 3/8" - 12"
P0684	9"	ADJ.	ADJ.	2 1/8"	3 3/8" - 9"
P0712	5"	ADJ.	ADJ.	2 1/8"	3 3/8" - 9"
P0795 / P0796	9"	15"	6"	2 1/8"	3" - 11"
P0803	5"	11"	6"	2 1/8"	3" - 11"
P0891	5 1/2"	15"	1 3/4"	2 1/8"	7"
P0969	7 1/2"	16"	3"	2 1/8"	7"
P1002	8"	13 1/2"	4 1/4"	2 1/8"	7"
P1009	7"	14"	2"	2 1/8"	7"
P1013	7"	14"	2"	2 1/8"	7"
P1015	8"	13"	10"	2 1/8"	7"

OVER THE RIM FAUCET/SUPPLY SETS

ITEM #	SPOUT EXTENSION	CENTER TO CENTER	SUPPLY ONLY HEIGHT	TOTAL HEIGHT	SPOUT DROP
P0972	10 1/2"	3 3/8"	24"	34"	N/A
P0972-28	10 1/2"	3 3/8"	28"	38"	N/A
P0973	10 1/2"	7"	24"	33"	4 1/2"
P0973-28	10 1/2"	7"	28"	37"	4 1/2"
P0974	11"	7"	24"	35"	4 1/2"
P0974-28	11"	7"	28"	39"	4 1/2"
P0975	10 1/2"	7"	24"	33"	4 1/2"
P0975-28	10 1/2"	7"	28"	37"	4 1/2"
P1000	11"	7"	24"	33"	5"
P1000-28	11"	7"	28"	37"	5"
P1019-28	13"	7"	28"	94"	N/A
P1020-28	10 1/2"	3 3/8"	28"	94"	N/A
P1023	13"	7"	24"	35"	1 1/2"
P1023-28	13"	7"	28"	39"	1 1/2"
P1024	12"	7"	24"	34"	N/A
P1024-28	12"	7"	28"	38"	N/A
P1025	10 1/2"	7"	24"	33"	4 1/2"
P1025-28	10 1/2"	7"	28"	37"	4 1/2"
P1025-30	10 1/2"	7"	30"	39"	4 1/2"
P1032	14"	7"	24"	35"	N/A
P1032-28	14"	7"	28"	39"	N/A

WALL MOUNT SHOWERS AND FAUCETS

ITEM #	Extension from wall to Spout or Head	Body C to C	Total height from Inlet	Bottom of Head or spout to Inlet
P0117	5 1/2"	8"	69"	N/A
P0655	11 1/2"	3 3/8"	9 3/4"	N/A
P0678	19"	3 3/8"	44"	36"
P0713	19"	3 3/8"	44"	36"
P0790**	10"	7"	7"	N/A
P0894	10 1/2"	7"	15"	N/A
P0901	19"	7"	45"	37"
P0902	19"	7"	48"	40"
P0903	Spout 8 1/2" / Head 19"	7"	45"	40"
P0905	12"	7"	10"	N/A
P0907	10"	7"	69"	58"
P0944**	10"	7"	7"	N/A
P0916	11"	N/A	N/A	N/A
P0946**	Spout 8 1/2" / Head 19"	7"	48"	40"
P0963**	Spout 8 1/2" / Head 19"	7"	64.5"	56.5"
P0970	13"	7"	11"	N/A
P1001	10"	7"	8 1/4"	N/A
P1016	Spout 11 1/2" / Head 15"	7"	10 1/2"	7"
P1021	11 1/2"	3 3/8"	65"	57 1/2"
P1022	12"	7"	42"	35"
P1027	10"	7"	7"	N/A
P1037	11 1/2"	3 3/8"	9 3/4"	N/A
P1049	Spout 8 1/2" / Head 15"	7"	64.5"	56.5"

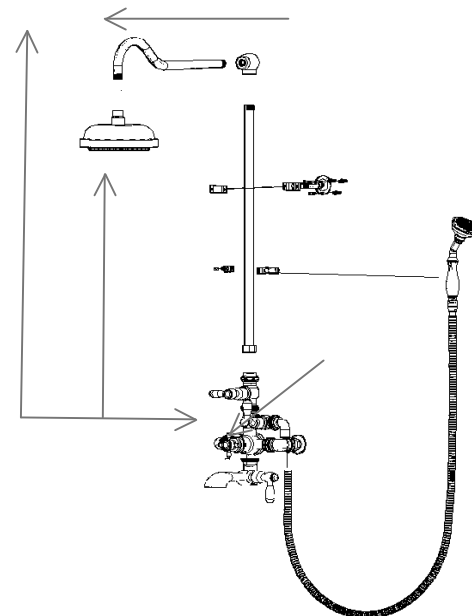

WALL MOUNT THERMO

****SPOUT DROP IS 4 1/2"**

TUB SPOUTS

ADAPT TO 3/4" IPS (except P0843 & P1044) MINIMUM OF 1 1/2" OF THREADS OUT OF WALL FOR INSTALLATION.

ITEM #	LENGTH	BASE DIAMETER	
P0057	5 1/2"	2 3/4"	
P0079	5 3/4"	3"	
P0080	5 3/4"	3 1/2"	
P0390	5 3/4"	3 5/8"	
P0728	7 1/2"	2 7/8"	(Requires 4" of threading out of wall for connection)
P0843C**	6 1/2"	2 3/8"	**Connection is 1/2" IPS
P1044**	10 1/2"	2 3/8"	**Connection is 1/2" IPS

KITCHEN FAUCETS

8" CENTER TO CENTER ON ALL KITCHEN FAUCETS.

MAXIMUM COUNTER THICKNESS 1 1/8"

ITEM #	SPOUT EXTENSION	HEIGHT	BASE DIAMETER
P0825	15 1/2"	6"	2 1/8"
P0826	12 1/2"	9 1/2"	2 1/8"
P0827	15 1/2"	5 1/2"	2 1/8"
P0828	16 1/4"	3"	2 1/8"
P0829	10"	3"	2 1/8"
P0830	20 1/4"	11"	2 1/8"
P0831	12 1/2"	6"	2 1/8"
P0832	6 1/2"	6"	2 1/8"
P0833	18"	12"	2 1/8"
P0834	15 5/8"	5"	2 1/8"
P0835	12 5/8"	7"	2 1/8"
P0836	12 5/8"	7"	2 1/8"
P0886	10"	3"	2 1/8"
P0887	6 1/2"	6"	2 1/8"
P1010	10"	4 1/2"	2 1/8"
P1011	12 1/2"	9 1/2"	2 1/8"
P1045/P047	8"	2 1/2"	2 1/8"
P1046/P048	8"	4 3/4"	2 1/8"

FLOW RATES

Approximate GPM, tested at 60 PSI

Faucet	1/4 Turn Valve Flow Rate
P0006	7
P0012	2.2
P0013	2.2
P0058	2.2
P0126	10.1
P0146	8.1
P0149	8.8
P0400	7
P0550	2.2
P0819 / P0822	11
Exposed Thermostatic	6.5
Cealed Thermostatic	6.1
Ceramic Tub & Shower Valves	5.7
Lavatory Valves	1.5
All Shower Heads & P0869	2
Kitchen Faucets	1.8

WIDESPREAD LAVATORY FAUCETS

Minimum hole size for installation is 1 1/4". Maximum counter thickness is 1 1/2"

MISSISSIPPI SERIES	SPOUT EXTENSION	SPOUT HEIGHT	SPOUT BASE	ESC DIAMETER	ESCUTCHEON HEIGHT	HANDLE LENGTH
P0152	5 1/2"	3 1/2"	2 1/2"	2 7/8"	1 7/8"	3 1/4"
P0805	5 1/2"	3 1/2"	2 1/2"	2 7/8"	1 7/8"	2 1/16"
P0981	5 1/2"	3 1/2"	2 1/2"	2 7/8"	1 7/8"	3"

RIO GRANDE SERIES	SPOUT EXTENSION	SPOUT HEIGHT	SPOUT BASE	ESC DIAMETER	ESCUTCHEON HEIGHT	HANDLE LENGTH
P0588	7 1/2"	6 1/2"	2 1/4"	2 1/2"	1 3/4"	3"
P0888	7 1/2"	6 1/2"	2 1/4"	2 1/2"	1 3/4"	3 1/8"
P1033	7 1/2"	6 1/2"	2 1/4"	2 1/2"	1 3/4"	3 1/4"

SACRAMENTO SERIES	SPOUT EXTENSION	SPOUT HEIGHT	SPOUT BASE	ESC DIAMETER	ESCUTCHEON HEIGHT	HANDLE LENGTH
P0104**	5"	4 7/8"	2" / 2 1/2"	2 1/4"	1 1/2"	4"
P0140**	5"	4 7/8"	2" / 2 1/2"	2 1/4"	1 1/2"	3 1/4"
P0820**	5"	4 7/8"	2" / 2 1/2"	2 7/8"	1 3/4"	3 1/4"

ST. LAWRENCE SERIES	SPOUT EXTENSION	SPOUT HEIGHT	SPOUT BASE	ESC DIAMETER	ESCUTCHEON HEIGHT	HANDLE LENGTH
P0345	4 1/2"	4 1/2"	2 3/4"	2 3/4"	2"	3 1/4"
P0346	4 1/2"	4 1/2"	2 3/4"	2 3/4"	2"	2 7/8"
P0347	4 1/2"	4 1/2"	2 3/4"	2 3/4"	2"	2 1/2"
P1008	4"	12"	2 3/8"	2 3/4"	2"	4"

THAMES SERIES	SPOUT EXTENSION	SPOUT HEIGHT	SPOUT BASE	ESC DIAMETER	ESCUTCHEON HEIGHT	HANDLE LENGTH
P0376	5 1/2"	4"	2 3/4"	2 1/2"	1 3/4"	3 1/4"
P0377	5 1/2"	4"	2 3/4"	2 1/2"	1 3/4"	3 1/2"
P0378	5 1/2"	4"	2 3/4"	2 1/2"	1 3/4"	3 1/8"
P0821	5 1/2"	4"	2 3/4"	2 1/2"	1 3/4"	3"

**Includes 7/8" spout ring

ANTIQU REPRODUCTIONS

Minimum hole size for installation is 1", maximum counter thickness 1 1/4"

ITEM #	(A) SPOUT EXTENSION	(B) SPOUT HEIGHT	(C) BASE DIAMETER
P0012	4"	4 1/2"	1 7/8"
P0013	5 3/4"	6"	2 1/4"
P0058	5"	4"	2 3/8"
P0549-8	5"	5 1/2"	2 7/8"
P0549-12	5"	5 1/2"	2 7/8"
P0550-8	5"	8 1/2"	2 7/8"
P0550-12	5"	8 1/2"	2 7/8"
P0557-8	5"	8 1/2"	2 7/8"
P0557-12	5"	8 1/2"	2 7/8"
P0558-8	5"	8 1/2"	2 7/8"
P0558-12	5"	8 1/2"	2 7/8"
P0565-8	5"	5"	2 7/8"
P0565-12	5"	5"	2 7/8"
P0587	4"	4 1/2"	1 7/8"
P0598	4"	4 1/2"	1 7/8"
P0629	5"	8 1/2"	2 1/8"
P0630	5"	5 1/2"	2 1/8"
P0819	8"	8"	2 1/8"
P0822	8"	8"	2 1/8"
P1005	7 1/2"	11 1/2"	2 7/8"
P1006	5" / 3"***	11 1/4"	2 1/4"
P1007	5"	12"	2 7/8"
P1007-10	5"	12"	2 7/8"

**AS PICTURED - 5" from center ball forward to spout and 3" from inlet as pictured to spout.

ESCUTCHEONS

ITEM #	(D) DIAMETER	(E) HEIGHT
P0099	2 7/8"	1 7/8"
P0383	3 3/8"	2"
P0384	2 7/8"	1 3/4"
P0386	2 1/4"	1 1/2"
P0387	2 1/4"	1 1/2"
P0388	2 7/8"	1 3/4"
P0391	2 1/2"	1 3/4"
P0458	2 3/4"	2"
P0478	2 3/4"	2"
P0481	2 1/2"	1 3/4"
PP0259	2 1/4"	1 1/4"

HANDLES

3/8" ID, 16 splines

ITEM #	(F) STEM TO END	ITEM #	(F) ITEM TO END
P0202	3 1/8"	P0475	3"
P0204	4"	P0476	2 1/2"
P0206	2 3/4"	P0551	2"
P0207	3 1/2"	P0552	2"
P0208	3 1/2"	P0622	4"
P0212	2 1/2"	P0725	3 3/16"
P0214	3 1/2"	P0782	2 1/16"
P0215	3 1/2"	P0815	3"
P0217	3 1/4"	P0980	3"
P0219	3 1/4"	P0999	3 1/2"
P0220	2 1/4"		

CAST IRON - TRADITIONAL

ITEM #	OVERALL LENGTH	OVERALL WIDTH	OVERALL HEIGHT	FAUCET HOLES CENTER TO CENTER	BOTTOM OF TUB TO FLOOR	OVERFLOW HEIGHT TO BOTTOM OF TUB	SEAT AREA	WATER VOLUME GALLON	UNCRATED / CRATED WEIGHT - LBS
P0700	60.5"	30.5"	24"	3 3/8"	5.3"	12.5"	37" x 17"	36	352 / 485
P0731	48.5"	30.5"	22"	3 3/8"	4.7"	12.5"	27" x 15"	23	220 / 383
P0761	54.5"	30.5"	24"	3 3/8"	5.3"	12.5"	30" x 17"	31	319 / 449
P0764	66.5"	30.5"	24"	3 3/8"	5.3"	12.5"	43" x 17"	43	374 / 531
P0880	60.5"	30.5"	24"	3 3/8"	5.3"	15.5"	37" x 17"	41	352 / 485
P0885	60.5"	30.5"	24"	7"	5.3"	15.5"	37" x 17"	41	352 / 485
P1028	60.5"	30"	24"	3 3/8"	N/A	13"	37" x 17"	36	460 / 593
P1029	60.5"	30"	24"	N/A	N/A	13"	37" x 17"	41	460 / 593
P1030	60.5"	30"	24"	7"	N/A	13"	37" x 17"	41	460 / 593

CAST IRON - SLIPPER

ITEM #	OVERALL LENGTH	OVERALL WIDTH	OVERALL HEIGHT	FAUCET HOLES CENTER TO CENTER	BOTTOM OF TUB TO FLOOR	OVERFLOW HEIGHT TO BOTTOM OF TUB	SEAT AREA	WATER VOLUME GALLON	UNCRATED / CRATED WEIGHT - LBS
P0704	66.5"	30"	29" / 23"	N/A	6.3"	14.5"	41" x 17"	48	394 / 540
P0705	66.5"	30"	29" / 23"	7"	6.3"	14.5"	41" x 17"	48	394 / 540
P0760	61"	31"	32.3" / 25"	7"	5.3"	15.5"	38" x 15"	39	374 / 515
P0762	61"	31"	32.3" / 25"	N/A	5.3"	15.5"	38" x 15"	39	374 / 515

CAST IRON - DOUBLE ENDED SLIPPER

ITEM #	OVERALL LENGTH	OVERALL WIDTH	OVERALL HEIGHT	FAUCET HOLES CENTER TO CENTER	BOTTOM OF TUB TO FLOOR	OVERFLOW HEIGHT TO BOTTOM OF TUB	SEAT AREA	WATER VOLUME GALLON	UNCRATED / CRATED WEIGHT - LBS
P0767	72"	31.5"	29.5" / 21.5"	7"	5.3"	13.7"	34" x 15"	68	418 / 624
P0770	72"	31.5"	29.5" / 21.5"	N/A	5.3"	13.7"	34" x 15"	68	462 / 624
P0784	72"	31.5"	29.5" / 21.5"	7"	5.3"	13.7"	34" x 15"	68	418 / 624
P0785	72"	31.5"	29.5" / 21.5"	N/A	5.3"	13.7"	34" x 15"	68	462 / 624
P0883	72"	31.5"	30" / 21.5"	7"	7.5"	12.5"	34" x 15"	68	506 / 640
P0884	72"	31.5"	30" / 21.5"	N/A	7.5"	12.5"	34" x 15"	68	506 / 640

CAST IRON - DUAL ENDED

ITEM #	OVERALL LENGTH	OVERALL WIDTH	OVERALL HEIGHT	FAUCET HOLES CENTER TO CENTER	BOTTOM OF TUB TO FLOOR	OVERFLOW HEIGHT TO BOTTOM OF TUB	SEAT AREA	WATER VOLUME GALLON	UNCRATED / CRATED WEIGHT - LBS
P0765	66.5"	30.5"	24"	7"	6"	15.5"	45" x 17"	50	374 / 529
P0768	66.5"	30.5"	24"	N/A	6"	15.5"	45" x 17"	50	374 / 529
P0766	66.5"	30.5"	24"	7"	7.25"	17.25"	45" x 17"	50	475 / 635
P0769	66.5"	30.5"	24"	N/A	7.25"	17.25"	45" x 17"	50	466 / 635
P0777	61.5"	30.5"	24.5"	7"	7.25"	17.25"	41" x 17"	45	462 / 577
P0778	61.5"	30.5"	24.5"	N/A	7.25"	17.25"	41" x 17"	45	462 / 577
P0881	61.5"	30.5"	24"	7"	6"	15.5"	41" x 17"	45	352 / 520
P0882	61.5"	30.5"	24"	N/A	6"	15.5"	41" x 17"	45	352 / 520

CAST IRON - DROP-IN TUB

ITEM #	OVERALL LENGTH	OVERALL WIDTH	OVERALL HEIGHT	SEAT AREA	WATER VOLUME GALLON	UNCRATED / CRATED WEIGHT - LBS
P1031	60"	32"	18"	40.5" x 20"	56	310 / 425

CAST IRON - SHOWER PAN

ITEM #	OVERALL LENGTH	OVERALL WIDTH	OVERALL HEIGHT	STANDING AREA	BOTTOM OF PAN TO FLOOR	UNCRATED / CRATED WEIGHT - LBS
P0774	42"	42"	12.5"	35" x 35"	6"	220 / 336

CAST IRON - FARM HOUSE SINK

ITEM #	OVERALL LENGTH	OVERALL WIDTH	SINK ONLY HEIGHT - BOTTOM TO BOWL	SINK ONLY HEIGHT - TOP TO APRON	INTERIOR SINK SIZE	SIDEBOARD SIZE - EACH ONE ON BOTH SIDES OF SINK	P0814 SINK COUNTER HEIGHT WITH LEGS	FAUCET HOLES CENTER TO CENTER	UNCRATED / CRATED WEIGHT - LBS
P0812	60.25"	21"	22"	18"	24" x 16"	18" x 16"	N/A	8"	336 / 418
P0813	29" x 35"	N/A	N/A	N/A	N/A	N/A	N/A	N/A	58
P0814	60.25"	21"	22"	18"	24" x 16"	18" x 16"	30" to 36"	8"	389 / 476

ACRYLIC - DUAL

ITEM #	OVERALL LENGTH	OVERALL WIDTH	OVERALL HEIGHT	FAUCET HOLES CENTER TO CENTER	BOTTOM OF TUB TO FLOOR	OVERFLOW HEIGHT TO BOTTOM OF TUB	SEAT AREA	WATER VOLUME GALLON	UNCRATED / CRATED WEIGHT - LBS
P0772	75"	34.5"	24"	7"	6"	14 3/4"	53" x 19"	50	134/239
P0773	75"	34.5"	24"	N/A	6"	14 3/4"	53" x 19"	50	134/239
P0775	60"	34.5"	24"	7"	6"	14 3/4"	39" x 19"	38	110/202
P0776	60"	34.5"	24"	N/A	6"	14 3/4"	39" x 19"	38	110/202
P0948	66"	31"	24"	7"	5.25"	14 3/4"	43" x 15"	48	119/216
P0949	66"	31"	24"	N/A	5.25"	14 3/4"	43" x 15"	48	119/216
P0961	66"	31"	24"	7"	5"	14 3/4"	43" x 15"	48	130/227
P0962	66"	31"	24"	N/A	5"	14 3/4"	43" x 15"	48	130/227

ACRYLIC - SLIPPER

ITEM #	OVERALL LENGTH	OVERALL WIDTH	OVERALL HEIGHT	FAUCET HOLES CENTER TO CENTER	BOTTOM OF TUB TO FLOOR	OVERFLOW HEIGHT TO BOTTOM OF TUB	SEAT AREA	WATER VOLUME GALLON	UNCRATED / CRATED WEIGHT - LBS
P0951	67"	30"	23.25" / 28.75"	7"	5.25"	14 1/2"	45" x 18"	41	104/205
P0952	67"	30"	23.25" / 28.75"	N/A	5.25"	14 1/2"	45" x 18"	41	104/205
P0956	60"	32"	25" / 33.5"*	7"	5.5"	15 3/4"	38" x 16"	42	121/226
P0957	60"	32"	23 3/4" / 33.5"*	N/A	5.5"	15 3/4"	38" x 16"	42	121/226
P0964	60"	32"	23 3/4" / 33.5"*	7"	5.5"	15 3/4"	38" x 16"	42	121/226
P0965	60"	32"	23 3/4" / 33.5"*	N/A	5.5"	15 3/4"	38" x 16"	42	121/226

* LOW SIDE / HIGH SIDE

ACRYLIC - TRADITIONAL

ITEM #	OVERALL LENGTH	OVERALL WIDTH	OVERALL HEIGHT	FAUCET HOLES CENTER TO CENTER	BOTTOM OF TUB TO FLOOR	OVERFLOW HEIGHT TO BOTTOM OF TUB	SEAT AREA	WATER VOLUME GALLON	UNCRATED / CRATED WEIGHT - LBS
P0950	61"	30"	24"	3 3/8"	5.5"	13 1/2"	37" x 17"	46	119/211
P0978	61"	30"	24"	N/A	5.5"	13 1/2"	37" x 17"	46	119/211
P0979	61"	30"	24"	7" on Rim	5.5"	13 1/2"	37" x 17"	46	119/211

ACRYLIC - SOAKER

ITEM #	OVERALL LENGTH	OVERALL WIDTH	OVERALL HEIGHT	FAUCET HOLES CENTER TO CENTER	BOTTOM OF TUB TO FLOOR	OVERFLOW HEIGHT TO BOTTOM OF TUB	SEAT AREA	WATER VOLUME GALLON	UNCRATED / CRATED WEIGHT - LBS
P0879	70"	34"	28.5"	N/A	3.5"	13 1/4"	43" x 17"	62	139/253
P0945	70"	34"	25"	N/A	N/A	13 1/4"	43" x 17"	62	139/253
P1034	67"	32 3/4"	24"	N/A	N/A	14 1/2" INT	45" x 19"	55	115/220
P1035	71"	31 1/2"	22"	N/A	N/A	13 3/4" INT	47" x 17"	63	144/250
P1036	65"	30 3/4"	20 1/2" / 26 1/4"*	N/A	N/A	11 1/2" INT	37" x 19"	31	90/200

* LOW SIDE / HIGH SIDE

ACRYLIC - DOUBLE ENDED SLIPPER

ITEM #	OVERALL LENGTH	OVERALL WIDTH	OVERALL HEIGHT	FAUCET HOLES CENTER TO CENTER	BOTTOM OF TUB TO FLOOR	OVERFLOW HEIGHT TO BOTTOM OF TUB	SEAT AREA	WATER VOLUME GALLON	UNCRATED / CRATED WEIGHT - LBS
P0993	72"	31.5"	29.5" / 21.5"	7"	5.3"	13.7"	34" x 15"	68	226/388
P0994	72"	31.5"	29.5" / 21.5"	N/A	5.3"	13.7"	34" x 15"	68	226/388
P0995	72"	31.5"	29.5" / 21.5"	7"	5.3"	13.7"	34" x 15"	68	218/380
P0996	72"	31.5"	29.5" / 21.5"	N/A	5.3"	13.7"	34" x 15"	68	218/380
P0997	72"	31.5"	30" / 21.5"	7"	7.5"	12.5"	34" x 15"	68	216/378
P0998	72"	31.5"	30" / 21.5"	N/A	7.5"	12.5"	34" x 15"	68	216/378

Strom Blumbing

BY

Sign of  the Crab

3756 Omec Circle
Rancho Cordova, CA 95742
(916) 638-2722 / (800) 843-2722
Fax (916) 638-2725
www.signofthecrab.com
sales@signofthecrab.com